

2D REFERENCE SIZE(UNIT:mm)

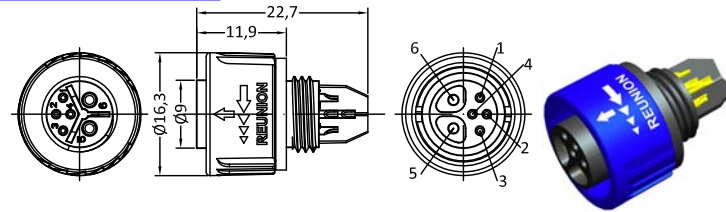

IMAGES FOR CONNECTOR ONLY

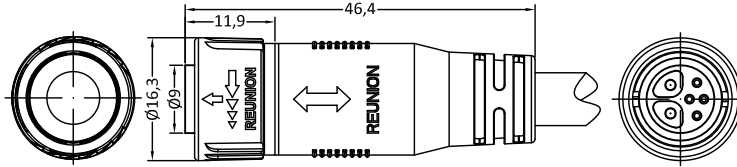

PART NUMBERING SYSTEM:

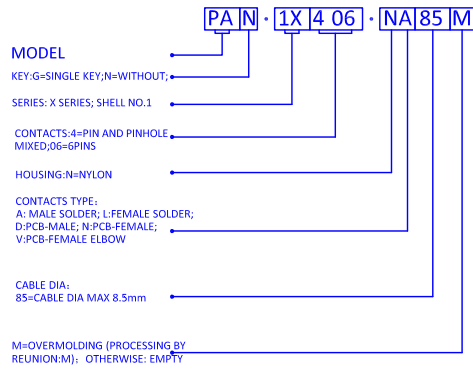

IMAGES FOR CONNECTOR PVERMOLDING

Housing material: PA6+25%GF;
 Contact material: Copper alloy;
 Contact type:Solder;
 Contact dia:Power:1.3mm;Signal:0.7mm;
 Rated current:Power:12A;Signal:6A;
 Rated voltage:Power:500V;Signal:200V;
 Insulation resistance:Power:1000MΩ;
 Signal:500MΩ;
 IP rating:IP67 waterproof;
 Working temp:-45°C~+125°C;
 Salt spray corrosion:> 24H;
 Fire rating:UL 94V0;
 Mating cycle:500 times;

*=CUSTOMERS CAN CHOOSE THE MODEL ACCORDING TO THEIR OWN NEEDS

P/N	CORE	TYPE	PIN DIA (mm)	WORK VOLTAGE (KV rms)	RATED CURRENT power/signal (A)	WORKING VOLTAGE power/signal(KV)
PAN.1X402.NA85M	2		2/1.3	1.5/0.6	12/6	0.5/0.2
PAN.1X403.NA85M	3		2/1.3 1/0.7	1.5/0.6	12/6	0.5/0.2
PAN.1X404.NA85M	4		2/1.3 2/0.7	1.5/0.6	12/6	0.5/0.2
PAN.1X405.NA85M	5		2/1.3 3/0.7	1.5/0.6	12/6	0.5/0.2
PAN.1X406.NA85M	6		2/1.3 4/0.7	1.5/0.6	12/6	0.5/0.2

*=CUSTOMERS CAN CHOOSE THE MODEL ACCORDING TO THEIR OWN NEEDS

2D REFERENCE SIZE(UNIT:mm)

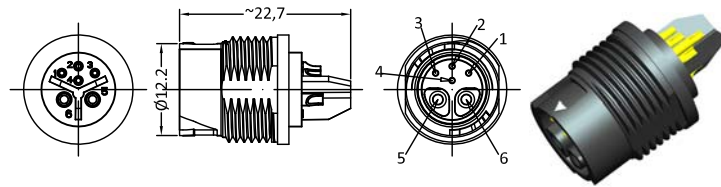

IMAGES FOR CONNECTOR ONLY

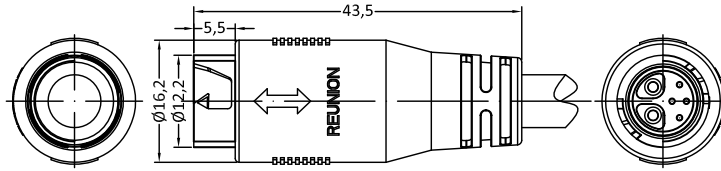

PART NUMBERING SYSTEM:

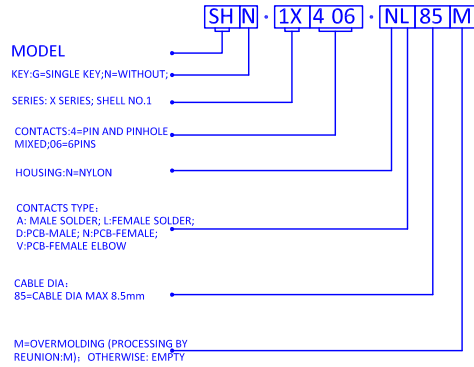

IMAGES FOR CONNECTOR PVERMOLDING

*=CUSTOMERS CAN CHOOSE THE MODEL ACCORDING TO THEIR OWN NEEDS

P/N	CORE	TYPE	PIN DIA (mm)	WORK VOLTAGE (KV rms)	RATED CURRENT power/signal (A)	WORKING VOLTAGE power/signal(KV)
SHN.1X402.NL85M	2		2/1.3	1.5/0.6	12/6	0.5/0.2
SHN.1X403.NL85M	3		2/1.3 1/0.7	1.5/0.6	12/6	0.5/0.2
SHN.1X404.NL85M	4		2/1.3 2/0.7	1.5/0.6	12/6	0.5/0.2
SHN.1X405.NL85M	5		2/1.3 3/0.7	1.5/0.6	12/6	0.5/0.2
SHN.1X406.NL85M	6		2/1.3 4/0.7	1.5/0.6	12/6	0.5/0.2